

# ON TIME'S POWDER KEG CONTROL PANEL DETAIL AND SERVICE INSTRUCTIONS

NO BATTERIES ARE INCLUDED WITH THE POWDER KEG

**CAUTION !**  
 WHEN WORKING WITH POWDER KEG UNIT  
 YOU MUST WEAR SAFETY GLASSES AND  
 KEEP HANDS AND FINGERS CLEAR OF ALL  
 GEARS AND ROTATING SHAFTS.  
 DISCONNECT ALL BATTERY POWER  
 WHILE WORKING ON THIS UNIT

## CONTROL PANEL REAR VIEW

WIRES TO THE  
DRIVE MOTOR  
**BLUE IS POSITIVE**  
**WHITE IS NEGATIVE**

IF THESE WIRES ARE REVERSED THE MOTOR WILL RUN IN REVERSE

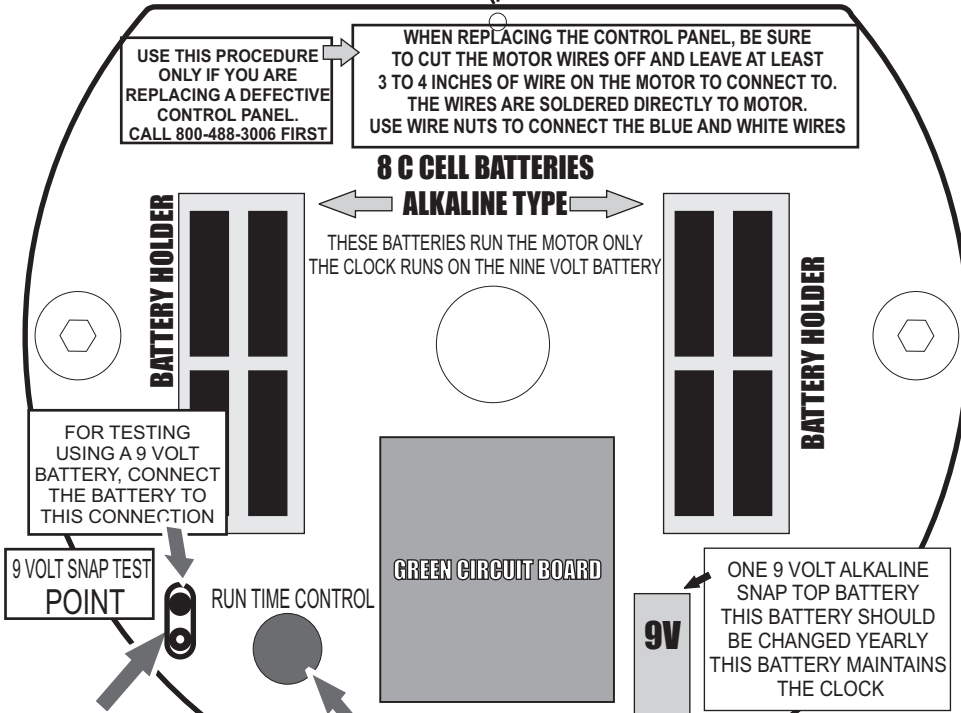

### TRUBLE SHOOTING TIPS

IN TROUBLE SHOOTING YOUR UNIT, IF THE MOTOR DOES NOT RUN, A 9 VOLT BATTERY MAY BE USED AT THE 9 VOLT TEST POINT. UN-SNAP THE MATING SNAP WHICH GOES TO THE C CELL PACKS AND CONNECT A FRESH 9 VOLT BATTERY AT THIS POINT. THIS WILL NOW RUN THE MOTOR. THIS WILL TELL IF THERE IS ANY PROBLEM WITH THE C CELLS OR THEIR BATTERY PACK HOLDER.

**CAUTION! DO NOT CONNECT TO THE SNAP PORTION THAT GOES TO THE C CELL PACKS. CONNECT ONLY TO THE SNAP PORTION THAT GOES TO THE CIRCUITS. IF YOU HAVE QUESTIONS ON THIS PROCEDURE PLEASE CALL 800-488-3006**

ALSO MAKE SURE YOU HAVE THE RUN TIME CONTROL SET AT A MID-WAY SETTING. IF IT IS TURNED FULLY COUNTER CLOCKWISE THE UNIT WILL NOT RUN.

### ON TIME FEEDERS HELP LINE 800-488-3006

IF YOU NEED SERVICE, PLEASE DO NOT SHIP YOUR BARREL ASSEMBLY. SHIP ONLY THE TOP LID ASSEMBLY, IN MANY CASES THE CONTROL PANEL ALONE CAN BE REPLACED WITH EXCHANGE OF THE OLD PART. CALL ONE OF OUR CUSTOMER SERVICE AGENTS TO VERIFY WHAT YOU SHOULD DO. PLEASE NOTE: SHIPPING CHARGES MAY APPLY THIS UNIT HAS A ONE YEAR WARRANTY. BE SURE TO KEEP YOUR RECEIPT.

## FIGURE 2. CONTROL PANEL FRONT VIEW

WIRES TO THE  
DRIVE MOTOR

**BLUE IS POSITIVE**  
**WHITE IS NEGATIVE**

IF THESE WIRES ARE REVERSED THE MOTOR WILL RUN IN REVERSE

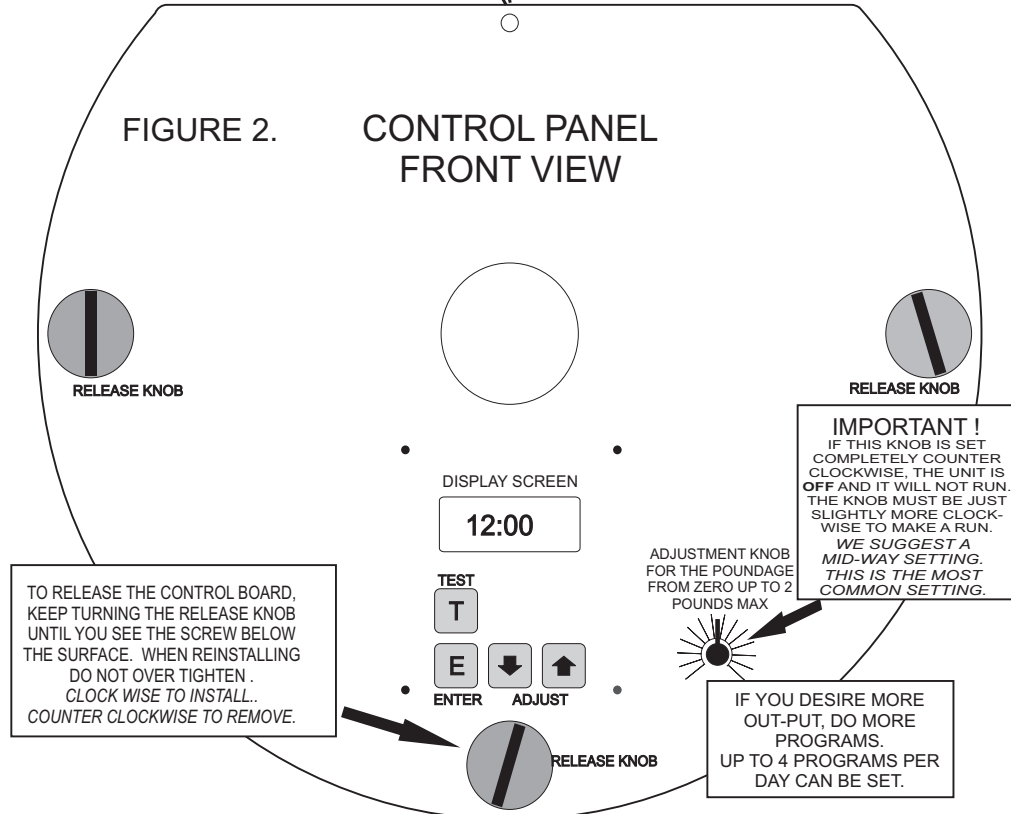

THE POWDER KEG IS  
MADE IN THE USA

ON TIME FEEDERS INC.  
 WE STOCK AT ALL TIMES  
 ALMOST EVERY PART OF THIS UNIT  
 THANK YOU FOR PURCHASING THIS USA PRODUCT

**OVER VIEW OF THE KEG**

THE POWDER KEG IS TRULY A NEW TYPE OF FEED DELIVERY. THE INTRODUCTION OF MANY DIFFERENT PRODUCTS USED FOR DEER ATTRACTANTS HAS DEMANDED A DIFFERENT APPROACH TO DELIVER MANY OF THE NEW POWDER BASE PRODUCTS. WE HAVE TESTED MOST OF THE PRODUCTS ON THE MARKET TODAY.

ON TIME'S APPROACH IS A MACHINE WITH EXTREME POWER TO KEEP THE POWDER BASE MATERIALS FLUFFED AND FRESH FOR DELIVERY. TO ACHIEVE THIS THE POWDER KEG IS A NEW BREED OF MACHINES USING A GEAR REDUCTION SYSTEM WHICH CAN MOVE THE ENTIRE HOPPER'S CONTENT. THIS IS DONE ON A VERY SLOW BUT EXTREMELY POWERFUL DELIVERY. YOU MIGHT BE VERY FAMILIAR WITH CONVENTIONAL DEER FEEDERS THAT CAN DO THEIR JOB IN ONLY SECONDS. THIS IS THE BIG DIFFERENCE IN THE KEG AND A REGULAR DEER FEEDER. THE KEG TAKES 5 MINUTES TO DELIVER ONE POUND OF PRODUCT. WHILE A STANDARD ON TIME FEEDER DOES THIS WORK IN ONLY 8 SECONDS. THE PROGRAM FOR THIS SYSTEM STILL USES THE 0 TO 30 SECOND FORMAT, BUT ON TIME HAS INSTALLED AN ADDITIONAL KNOB THAT ALLOWS THE USER TO EXTEND THE DELIVERY TIME FROM SECONDS TO MINUTES.

**CONTROL PANEL**

STEP 1. IN FIG.1 USING THE STEEL RING LEVER, REMOVE THE STEEL RING FROM THE TOP.

STEP 2. LIFT UP AND REMOVE THE TOP ASSEMBLY AND PLACE ON A LEVEL SURFACE IN AN UP SIDE DOWN POSITION AS IN FIG.2

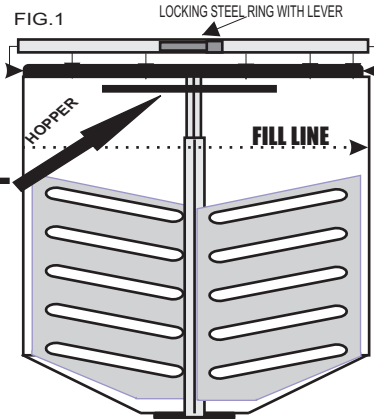

STEP 3. TO INSTALL BATTERIES, SEE THE CONTROL PANEL SHOWN ON BACK OF THIS PAGE. THE BATTERY COMPARTMENT IS ON THE UNDER SIDE OF THE CONTROL PANEL. 3 EASY TO TURN KNOBS HAVE BEEN PROVIDED FOR ACCESS TO THE UNDER SIDE. THE KNOBS HAVE A KEEPER THAT PREVENTS THE LOSS OF THE KNOB. ONCE YOU HAVE TURNED ALL 3 KNOBS COUNTER CLOCKWISE, YOU CAN LIFT THE CONTROL PANEL UP AND OFF OF THE DRIVE SHAFT. INSTALL 8 C CELL BATTERIES. USE ALKALINE TYPE BATTERIES. ALSO INSTALL ONE SNAP-TOP 9 VOLT BATTERY IN THE CONTROL PANEL TO MAINTAIN THE CLOCK. THE 9 VOLT BATTERY SHOULD LAST ONE YEAR OR MORE. (USE ALKALINE TYPE)

**9" STEEL ROD TOOL WITH YELLOW TAG**



SLIDE THE 9" STEEL ROD THRU THE SQUARE DRIVE SHAFT AND USE AS A TOOL TO TURN THE SHAFT IN A CLOCKWISE DIRECTION

**INSTRUCTIONS:**

STEP 4. SEE FIG. 2

PROGRAM YOUR UNIT.

- A. USING THE ENTER KEY, KEEP PRESSING AND RELEASING THE ENTER KEY UNTIL THE DISPLAY SHOWS TIME OF DAY.
  - B. NOW USE THE UP DOWN KEYS TO CHANGE THE DISPLAY TO THE CORRECT TIME OF DAY, NOW USE THE ENTER KEY ONE TIME TO DISPLAY THE NEXT COMMAND. WHICH WILL BE FEED TIME 1.
  - C. USING THE UP DOWN KEYS, SET THE DISPLAY TO THE DESIRED FEED TIME 1. NOW PRESS ENTER ONE TIME. THIS WILL NOW BRING UP THE FEED TIME DURATION. THIS CAN BE ADJUSTED FROM 0 UP TO 30 SEC. USE THE UP DOWN KEYS TO MAKE THIS READING YOUR DESIRED DURATION. NOW PUSH ENTER. THIS NOW BRINGS UP THE FEED TIME 2. IF YOU DO NOT DESIRE TO USE FEED TIME #2, SET THE DURATION TO 00. THE UNIT WILL NOW INDICATE " OFF". THIS WILL CONCLUDE YOUR PROGRAM.
  - D. IF YOU WANT TO INCLUDE THE FEED TIME 2, USE THE UP DOWN KEYS TO SET THE DESIRED FEED DURATION FROM 00 UP TO 30 SECONDS YOU MAY USE UP TO 4 PROGRAMS
  - E. AFTER PROGRAMING HAS CONCLUDED, PUSH THE ENTER KEY AND THE UNIT WILL SAY ARMED. IT IS NOW READY TO TEST. PRESS TEST AND THE UNIT WILL COUNT DOWN FROM 10 AND WILL RUN FOR A DURATION OF YOUR PROGRAMMED FEED TIME. THE TEST WILL YIELD AN ACTUAL FEED CYCLE.
- NOTE: SET THE DELIVERY KNOB (FIG.2) TO A MID-WAY SETTING. ( ABOUT A POUND) YOU MAY ALSO SELECT LESS THAN ONE POUND. THE SECONDS SELECTED IN THE PROGRAM SELECTIONS ABOVE ARE ADDED TO THE TOTAL DELIVERY.**

**TIP: IF YOU HOLD THE ADJUST KEY IT WILL PAUSE THEN GO INTO RAPID MOVEMENT**

**CAUTION !**  
WEAR SAFETY GLASSES WHILE WORKING WITH THIS PRODUCT. ALSO KEEP HANDS AND FINGERS AWAY FROM MOTOR DRIVE SHAFT AND ALL GEARS !  
WARNING: CONTAINS POWERFUL MAGNETS.  
PINCHING HAZARD. DO NOT INGEST OR INHALE MAGNETS.  
ATTRACTION OF MAGNETS IN THE BODY MAY CAUSE SERIOUS INJURY AND REQUIRE IMMEDIATE MEDICAL CARE. MAGNETS MAY CAUSE INTERFERENCE WITH CARDIAC DEVICES INCLUDING PACEMAKERS AND POSE POTENTIAL HAZARDS TO PATIENTS. KEEP AWAY FROM SMALL CHILDREN. KEEP AWAY FROM TV'S, VCR TAPES AND ALL MAGNETIC MEDIA.

STEP 6. AFTER PROGRAMMING, RE-INSTALL THE TOP ASSEMBLY AS IN FIG.3. MATCH THE DRIVE SHAFT OF THE TOP ASSEMBLY TO MATCH THE DRIVE SHAFT OF THE HOPPER. THE DRIVE SHAFTS SLIDE TOGETHER. YOU MAY ROTATE THE TOP TO LINE UP THE SQUARE SHAFT TO FIT INSIDE THE MATING SHAFT. SLIDE THE TOP DOWN TO FIT THE TOP OF THE HOPPER. SECURE THE TOP USING THE LEVER LOCKING STEEL BAND AS SHOWN IN FIG.1.

FIG.3

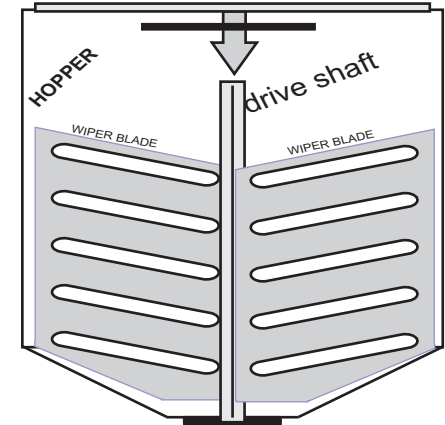

STEP 7. INSTALL THE STEEL RING WITH THE 3 STUBBY LEGS AROUND THE HOPPER. INSTALL THE SECTIONAL LEGS ON TO THE STUBBY LEGS. ONLY ONE BOLT IS USED

THE STEEL LEG RING IS NOT SHOWN IN THESE ILLUSTRATIONS

**IMPORTANT !**

BY HAND USE THE 9" STEEL ROD AS A TOOL TO MANUALLY TURN DRIVE SHAFT TWO TURNS CLOCKWISE

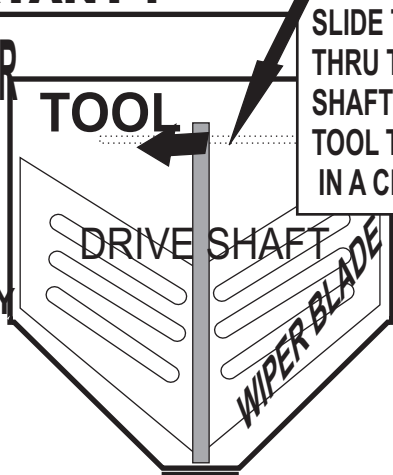

**IMPORTANT !**

AFTER FILLING, USE THIS TOOL TO MANUALLY TURN DRIVE SHAFT TWO TURNS CLOCKWISE THE WIPER BLADES SHOULD COIL AROUND THE DRIVE SHAFT. THIS IS THE CORRECT POSITION FOR THE WIPER BLADES AFTER FILLING. THIS PROCEDURE SHOULD BE FOLLOWED WITH EACH FILL-UP.

**CLOCKWISE LOOKING DOWN INTO THE HOPPER**

**INSTALL THE MOTOR LID ASSEMBLY ONLY AFTER THE ABOVE PROCEDURE.**