



# POWDER KEG

## OVER VIEW OF THE KEG

THE POWDER KEG IS TRULY A NEW TYPE OF FEED DELIVERY. THE INTRODUCTION OF MANY DIFFERENT PRODUCTS USED FOR DEER ATTRACTANTS HAS DEMANDED A DIFFERENT APPROACH TO DELIVER MANY OF THE NEW POWDER BASE PRODUCTS. WE HAVE TESTED MOST OF THE PRODUCTS ON THE MARKET TODAY. ON TIME'S APPROACH IS A MACHINE WITH EXTREME POWER TO KEEP THE POWDER BASE MATERIALS FLUFFED AND FRESH FOR DELIVERY. TO ACHIEVE THIS THE POWDER KEG IS A NEW BREED OF MACHINES USING A GEAR REDUCTION SYSTEM WHICH CAN MOVE THE ENTIRE HOPPER'S CONTENT. THIS IS DONE ON A VERY SLOW BUT EXTREMELY POWERFUL DELIVERY. YOU MIGHT BE VERY FAMILIAR WITH CONVENTIONAL DEER FEEDERS THAT CAN DO THEIR JOB IN ONLY SECONDS. THIS IS THE BIG DIFFERENCE IN THE KEG AND A REGULAR DEER FEEDER. THE KEG TAKES 3.5 MINUTES TO DELIVER ONE POUND OF PRODUCT. WHILE A STANDARD ON TIME FEEDER DOES THIS WORK IN ONLY 8 SECONDS. THE PROGRAM FOR THIS SYSTEM STILL USES THE 0 TO 30 SECOND FORMAT, BUT ON TIME HAS INSTALLED AN ADDITIONAL KNOB THAT ALLOWS THE USER TO EXTEND THE DELIVERY TIME FROM SECONDS TO MINUTES. SINCE MOST USERS DON'T LIKE COMPLICATED COMPUTATIONS, WE USED A SIMPLE 1,2,3, ON THE KNOB TO INDICATE 1 POUND OR 2 POUNDS OR THE MAXIMUM PER PROGRAM OUTPUT OF 3 POUNDS. SINCE THE TEST PROCEDURE WOULD REQUIRE THE USER TO REMOVE THE TOP, WE HAVE INCLUDED A MAGNETIC KEY CHAIN TO TEST YOUR UNIT WITHOUT REMOVING THE LID OR TOP. ONCE THE UNIT HAS BEEN PROGRAMMED THE USER MAY WAVE THE KEY CHAIN OVER THE TEST SPOT ON THE TOP AND, LIKE MAGIC, THE UNIT DOES A 10 SECOND COUNT DOWN AND DELIVERS THE EXACT AMOUNT THAT YOU PROGRAMMED. WE HAVE PROVIDED A TOLL FREE PHONE NUMBER FOR YOUR QUESTIONS, 800-488-3006. WE WILL ALSO HAVE INTERNET INSTRUCTIONS AT [www.ontimefeeders.com](http://www.ontimefeeders.com)

STEP 1. IN FIG.1 USING THE STEEL RING LEVER, REMOVE THE STEEL RING FROM THE TOP.

STEP 2. LIFT UP AND REMOVE THE TOP ASSEMBLY AND PLACE ON A LEVEL SURFACE IN AN UP SIDE DOWN POSITION AS IN FIG.2

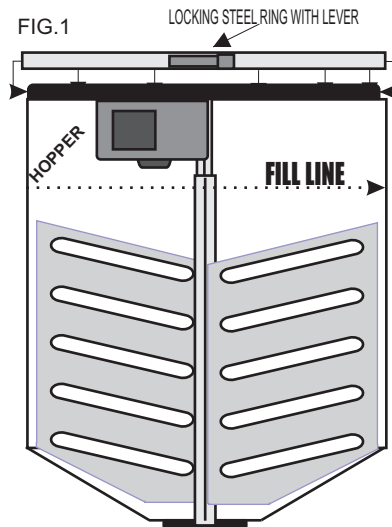

STEP 3. TO OPEN THE BATTERY COMPARTMENT PULL AND TILT OUT THE DOOR TO GAIN ACCESS INSTALL ALL NEW 8 C CELL BATTERIES WHICH WILL YIELD 12 VOLTS FOR OPERATING THE KEG. USE CAUTION IN REPLACING THE DOOR AS THE MAGNETIC DOOR CAN PINCH YOUR FINGERS. USE CARE!

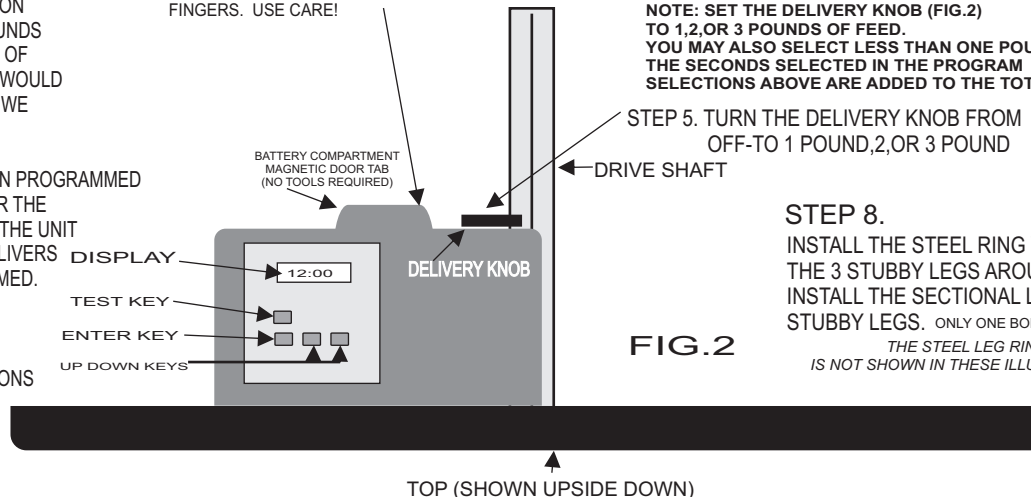

FIG.2

## INSTRUCTIONS:

STEP 4. SEE FIG. 2

PROGRAM YOUR UNIT.

- USING THE ENTER KEY, KEEP PRESSING AND RELEASING THE ENTER KEY UNTIL THE DISPLAY SHOWS TIME OF DAY.
  - NOW USE THE UP DOWN KEYS TO CHANGE THE DISPLAY TO THE CORRECT TIME OF DAY, NOW USE THE ENTER KEY ONE TIME TO DISPLAY THE NEXT COMMAND, WHICH WILL BE FEED TIME 1.
  - USING THE UP DOWN KEYS, SET THE DISPLAY TO THE DESIRED FEED TIME 1. NOW PRESS ENTER ONE TIME. THIS WILL NOW BRING UP THE FEED TIME DURATION. THIS CAN BE ADJUSTED FROM 0 UP TO 30 SEC. USE THE UP DOWN KEYS TO MAKE THIS READING YOUR DESIRED DURATION. NOW PUSH ENTER. THIS NOW BRINGS UP THE FEED TIME 2. IF YOU DO NOT DESIRE TO USE FEED TIME #2, SET THE DURATION TO 00. THE UNIT WILL NOW INDICATE " OFF". THIS WILL CONCLUDE YOUR PROGRAM.
  - IF YOU WANT TO INCLUDE THE FEED TIME 2, USE THE UP DOWN KEYS TO SET THE DESIRED FEED DURATION FROM 00 UP TO 30 SECONDS YOU MAY USE UP TO 4 PROGRAMS
  - AFTER PROGRAMMING HAS CONCLUDED, PUSH THE ENTER KEY AND THE UNIT WILL SAY ARMED. IT IS NOW READY TO TEST. PRESS TEST AND THE UNIT WILL COUNT DOWN FROM 10 AND WILL RUN FOR A DURATION OF YOUR PROGRAMMED FEED TIME. THE TEST WILL YIELD AN ACTUAL FEED CYCLE.
- NOTE: SET THE DELIVERY KNOB (FIG.2) TO 1,2,OR 3 POUNDS OF FEED. YOU MAY ALSO SELECT LESS THAN ONE POUND. THE SECONDS SELECTED IN THE PROGRAM SELECTIONS ABOVE ARE ADDED TO THE TOTAL DELIVERY.**

STEP 5. TURN THE DELIVERY KNOB FROM OFF-TO 1 POUND,2,OR 3 POUND

STEP 8. INSTALL THE STEEL RING WITH THE 3 STUBBY LEGS AROUND THE HOPPER. INSTALL THE SECTIONAL LEGS ON TO THE STUBBY LEGS. ONLY ONE BOLT IS USED  
THE STEEL LEG RING IS NOT SHOWN IN THESE ILLUSTRATIONS

## CAUTION !

WEAR SAFETY GLASSES WHILE WORKING WITH THIS PRODUCT. ALSO KEEP HANDS AND FINGERS AWAY FROM MOTOR DRIVE SHAFT AND ALL GEARS !

WARNING:CONTAINS POWERFUL MAGNETS. PINCHING HAZARD. DO NOT INGEST OR INHALE MAGNETS. ATTRACTION OF MAGNETS IN THE BODY MAY CAUSE SERIOUS INJURY AND REQUIRE IMMEDIATE MEDICAL CARE. MAGNETS MAY CAUSE INTERFERENCE WITH CARDIAC DEVICES INCLUDING PACEMAKERS AND POSE POTENTIAL HAZARDS TO PATIENTS. KEEP AWAY FROM SMALL CHILDREN. KEEP AWAY FROM TV'S, VCR TAPES AND ALL MAGNETIC MEDIA.

STEP 6. AFTER PROGRAMMING, RE-INSTALL THE TOP ASSEMBLY AS IN FIG.3. MATCH THE DRIVE SHAFT OF THE TOP ASSEMBLY TO MATCH THE DRIVE SHAFT OF THE HOPPER. THE DRIVE SHAFTS SLIDE TOGETHER. YOU MAY ROTATE THE TOP TO LINE UP THE SQUARE SHAFT TO FIT INSIDE THE MATING SHAFT. SLIDE THE TOP DOWN TO FIT THE TOP OF THE HOPPER. SECURE THE TOP USING THE LEVER LOCKING STEEL BAND AS SHOWN IN FIG.1.

STEP 7. TESTING WITH THE MAGNETIC KEY CHAIN: RUB MAGNETIC PORTION OF KEY CHAIN OVER THE TEST SPOT ON THE TOP YOU MUST MAKE AT LEAST TWO PASSES. THIS WILL START A 10 SECOND COUNTDOWN. YOUR UNIT WILL MAKE A TEST RUN.

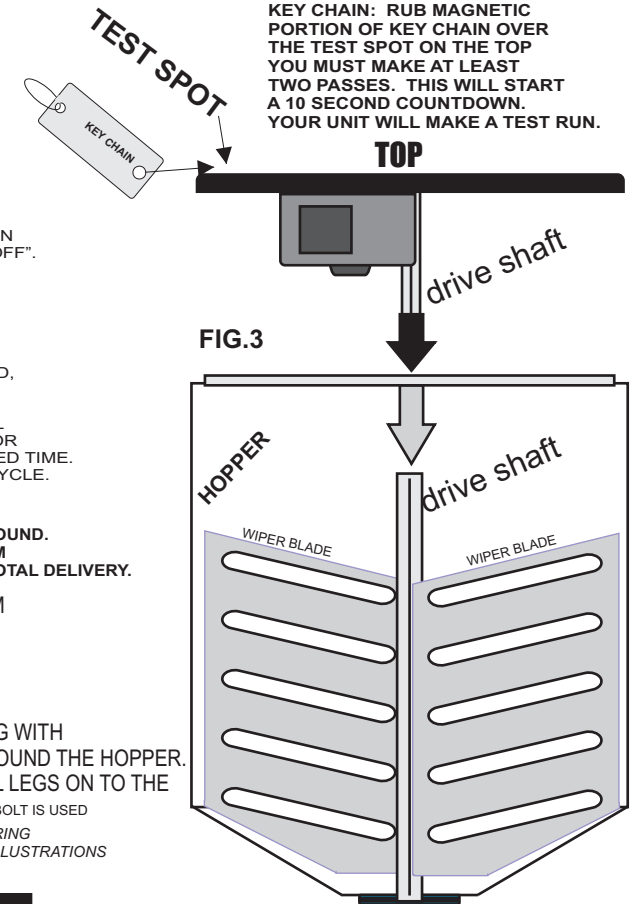

FIG.3